

(ST) S/N:

Nitrocarburised piston rod

Low friction bearing surfaces

Anti-extrusion seals

Collar threads withstand full load

Piston rod thread on all models up to 30 tonnes

Base mounting holes on all models (except HSS308)

Optional piston rod saddles

Collar thread protector supplied as standard

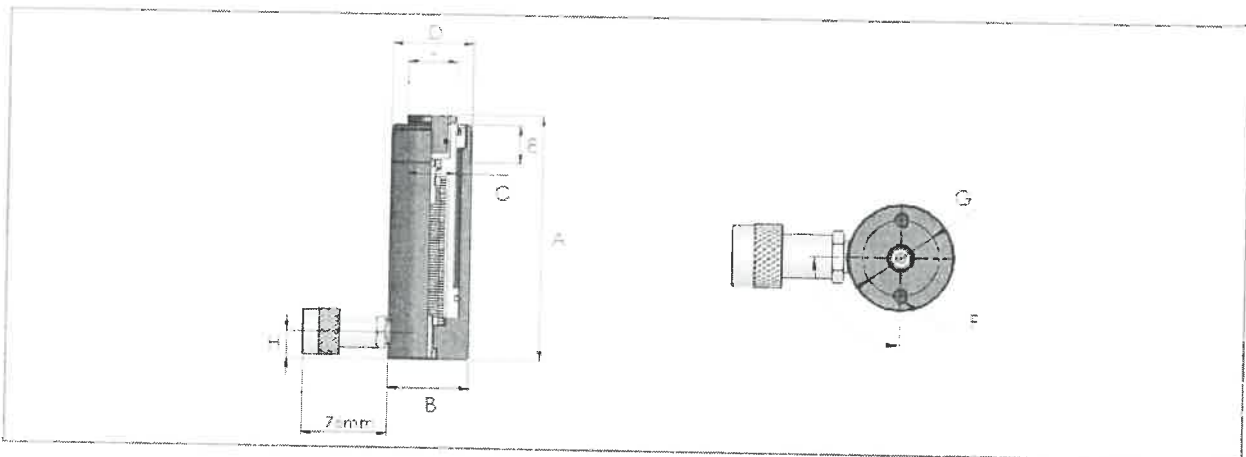

RODB HEHB @SHN MR

MODEL NO.	CAPACITY TONNES	STROKE MM	OIL CAP. CM ³	CYL. EFF. AREA CM ²	WEIGHT KG
HSS51	4.5	25	16	6.4	1.0
HSS52	4.5	50	32	6.4	1.2
HSS53	4.5	75	48	6.4	1.4
HSS54	4.5	100	64	6.4	1.5
HSS55	4.5	125	80	6.4	1.8
HSS57	4.5	176	113	6.4	2.0
HSS59	4.5	227	146	6.4	2.4
HSS101	10	25	36	14.4	1.8
HSS102	10	56	81	14.4	2.4
HSS104	10	100	144	14.4	3.0
HSS150	15	150	217	14.4	4.2

CH DMRHN MR HM L L

MODEL NO.	A	B	C	D	E	F	G	H
HSS51	107	38	24	1 1/2"-16un	28	M6	25	19
HSS52	132	38	24	1 1/2"-16un	28	M6	25	19
HSS53	157	38	24	1 1/2"-16un	28	M6	25	19
HSS54	182	38	24	1 1/2"-16un	28	M6	25	19
HSS55	207	38	24	1 1/2"-16un	28	M6	25	19
HSS57	258	38	24	1 1/2"-16un	28	M6	25	19
HSS59	308	38	24	1 1/2"-16un	28	M6	25	19
HSS101	100	57	35	2 1/4"-14un	27	M8	40	19
HSS102	131	57	35	2 1/4"-14un	27	M8	40	19
HSS104	175	57	35	2 1/4"-14un	27	M8	40	19
HSS106	225	57	35	2 1/4"-14un	27	M8	40	19
HSS108	281	57	35	2 1/4"-14un	27	M8	40	19
HSS1010	325	57	35	2 1/4"-14un	27	M8	40	19
HSS1012	379	57	35	2 1/4"-14un	27	M8	40	16
HSS152	154	70	41	2 3/4"-16un	39	M10	48	19.0
HSS154	204	70	41	2 3/4"-16un	39	M10	48	19.0
HSS156	254	70	41	2 3/4"-16un	39	M10	48	19.0
HSS1510	354	70	41	2 3/4"-16un	39	M10	48	19.0
HSS252	174	86	54	3 5/16"-12un	49	M12	60	25.0
HSS254	225	86	54	3 5/16"-12un	49	M12	60	25.0
HSS256	273	86	54	3 5/16"-12un	49	M12	60	25.0
HSS258	324	86	54	3 5/16"-12un	49	M12	60	25.0
HSS2510	480	86	54	3 5/16"-12un	49	M12	60	25.0

Cnv rln`c B`s` kn f i dr (Gss://V v v .gh @rj`-@-P t dr slm m(Gsso://V y v .gh En d d .bnl /Dm
 En d d .bnl /Dm Tj /Cnv rln`c- 3 5/16"-12un 49 M12 60 25.0
 Tj /Dm p t h p /B nl l nm /0/@rj`-@-P t dr slm m)
 En d d /B nl 480 m /0/@rj`-@-P t dr slm m) 3 5/16"-12un 49 M12 60 25.0